

Making a Revival

The Handa Red Brick Building

Born as the Brewery for Kabuto Beer

The Handa Red Brick Building was born in 1898 as the brewery for Kabuto Beer. It boasted a size that put it among brick buildings erected during the Meiji period (1868-1912) that can be counted on the fingers of one hand. Old remnants of beer plants still existing are exceedingly few, and the structure is valuable in this sense as well.



Corridor inside the building

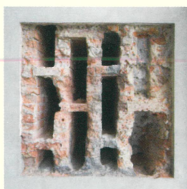

Five-layer wall

Restored

Long-unavailable Kabuto Beer Makes a Comeback

Taking Up the Challenge of Brewing Authentic Beer, and Winning the Gold Medal at the 1900 Paris Expo

In May 1889, the first shipment was made from Handa of 3,000 bottles of a beer named Marusan Beer, by Matazaemon Nakano, the fourth-generation owner of the vinegar-maker Mitsukan Suten, and Zempei Morita, founder of bread-maker Shikishima Baking. This later became Kabuto Beer. In 1898 the company brought in a machinist and brewmaster from Germany, and in Enokishita, Handa-cho, the Handa Red Brick Building was completed and became the new beer brewery. The company began brewing authentic German beer and changed its name to "Kabuto Bakushu," and two years later the beer was exhibited at the 1900 Paris Exhibition Universelle, winning the gold medal.



Overview of the Handa Red Brick Building

Establishment (primary construction)	Completed October 31, 1898
Basic design	Germania Maschinenfabrik, Germany
Final design	Yorinaka Tsumaki
Building area	2786.99 m ²
Total floor space	4979.51 m ² (portion used: 2729.93m ²)
Building height	20.84 m
Building construction	Brick and plain wood (half-timber construction)
Size	2 above-ground stories, 2-story penthouse
National certifications, etc.	2004: Agency for Cultural Affairs registration: Registered Tangible Cultural Properties No. 23-0134 through -0136; 2009: Ministry of Economy, Trade, and Industry certified Heritage of Industrial Modernization; 2014: City of Handa designated Structure of Landscape Importance No. 1

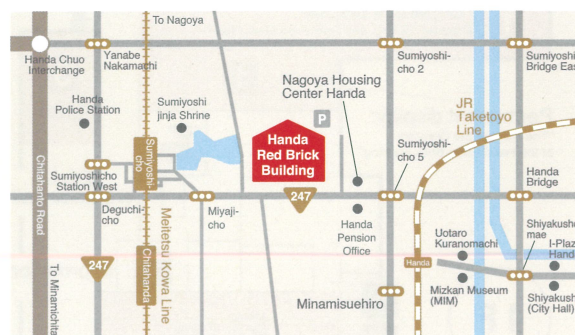

Transit Information

Via Meitetsu Kowa Line:
5 minutes on foot east from Sumiyoshicho Station
Via JR Taketoyo Line:
15 minutes on foot northwest from Handa Station
Via Chitahanto Road:
10 minutes by car from Handa Chuo Interchange

Location

8 Enokishita-cho, Handa, Aichi Prefecture

Contact

The Handa Red Brick Building
Phone: 0569-24-7031 Fax: 0569-24-7033

Handa Red Brick Building website

<https://handa-akarenga.jp/en/>

E-mail: info@handa-akarenga.jp

The Handa Red Brick Building

Site Guide

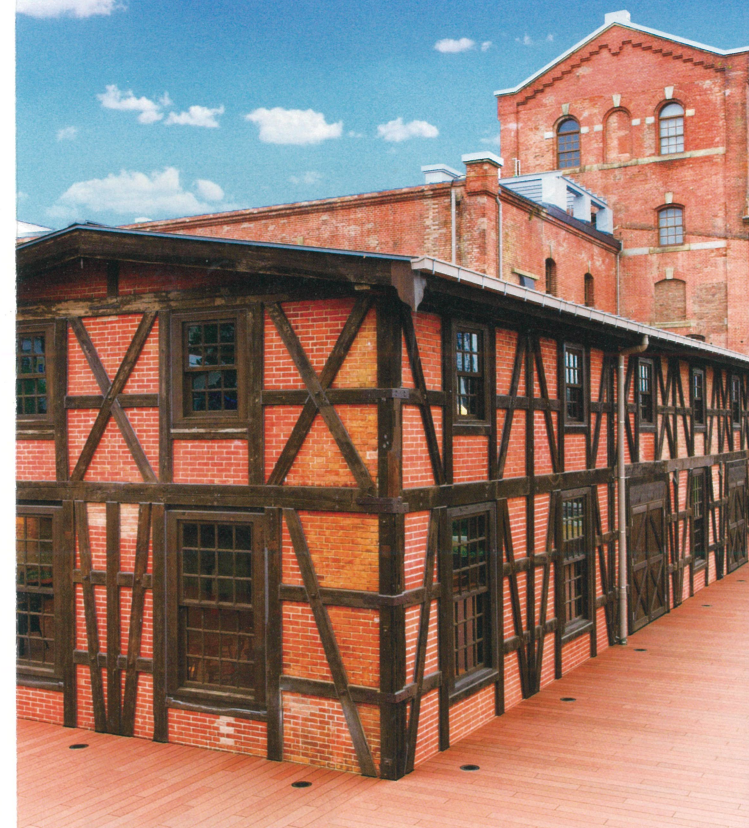

Get high on the carved-out history.

半田赤レンガ建物
HANDA RED BRICK BUILDING

Taste, Learn, Marvel, and Encounter ... So Many Different Ways to Enjoy!

Floor Map

1. Permanent Display

Encounter the passion of the predecessors who took up the challenge of authentic beer-making

Models, videos, photographs from the era, and other materials showcase the history behind the birth of the Handa Red Brick Building and Kabuto Beer. You can feel the burning enthusiasm our forerunners had for making things.

Hours 9:00 am to 5:00 pm

Closed Year-end and New Year's holidays

Permanent display area admission fees (including tax)	Entry type	Adult (high-school student and up)	Middle-school student and under
	Individual	200 yen	Free
	Group (20 persons or more)	160 yen	Free



Permanent display: "Creating, Selling, and Reviving Kabuto Beer"



Permanent display: "The Story of the Creation of the Handa Red Brick Building"

We hope to convey the appeal of this historic building and draft Kabuto Beer.

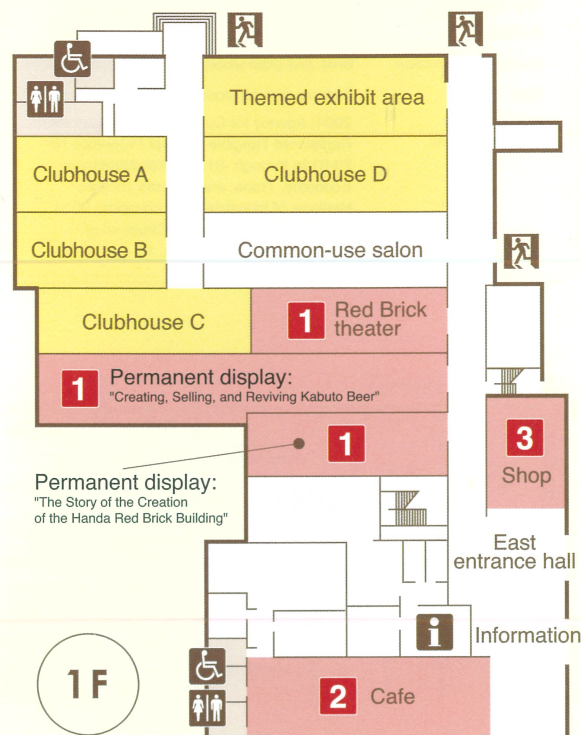

1F

2. Cafe

Taste the flavor of Kabuto Beer and snacks made using local ingredients.

In a mystical and relaxing space enclosed in red brick, you can enjoy resurrected Kabuto Beer and tasty snacks made using local ingredients.

Hours 10:00 am to 5:00 pm

Closed Year-end and New Year's holidays



Cafe



Open terrace

3. Shop

A careful selection of discerning products from the Chita Peninsula

In addition to bottled Kabuto Beer and other Kabuto Beer merchandise, a variety of fine products from Handa and the Chita Peninsula are available for purchase.

Hours 10:00 am to 5:00 pm

Closed Year-end and New Year's holidays



The birth of sourcepoints for making things

Clubhouses and Themed Exhibit Area

The clubhouses and the themed exhibit area are rental areas that give full play to the ambience of the building's walls. Local residents and visitors are welcome to make use of these spaces as sourcepoints for cultural and artistic endeavors, and other forms of making things.

Hours 9:00 am to 5:00 pm

Closed Year-end and New Year's holidays

Clubhouses These are available for cultural and artistic activities, as well as community events and a variety of other uses.

Themed exhibit area This is available for use as a place to exhibit artwork and photography, and for other creative endeavors.

